

PLAINS

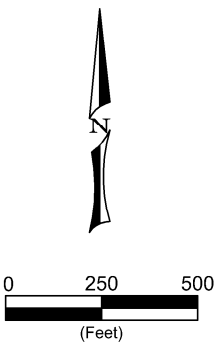
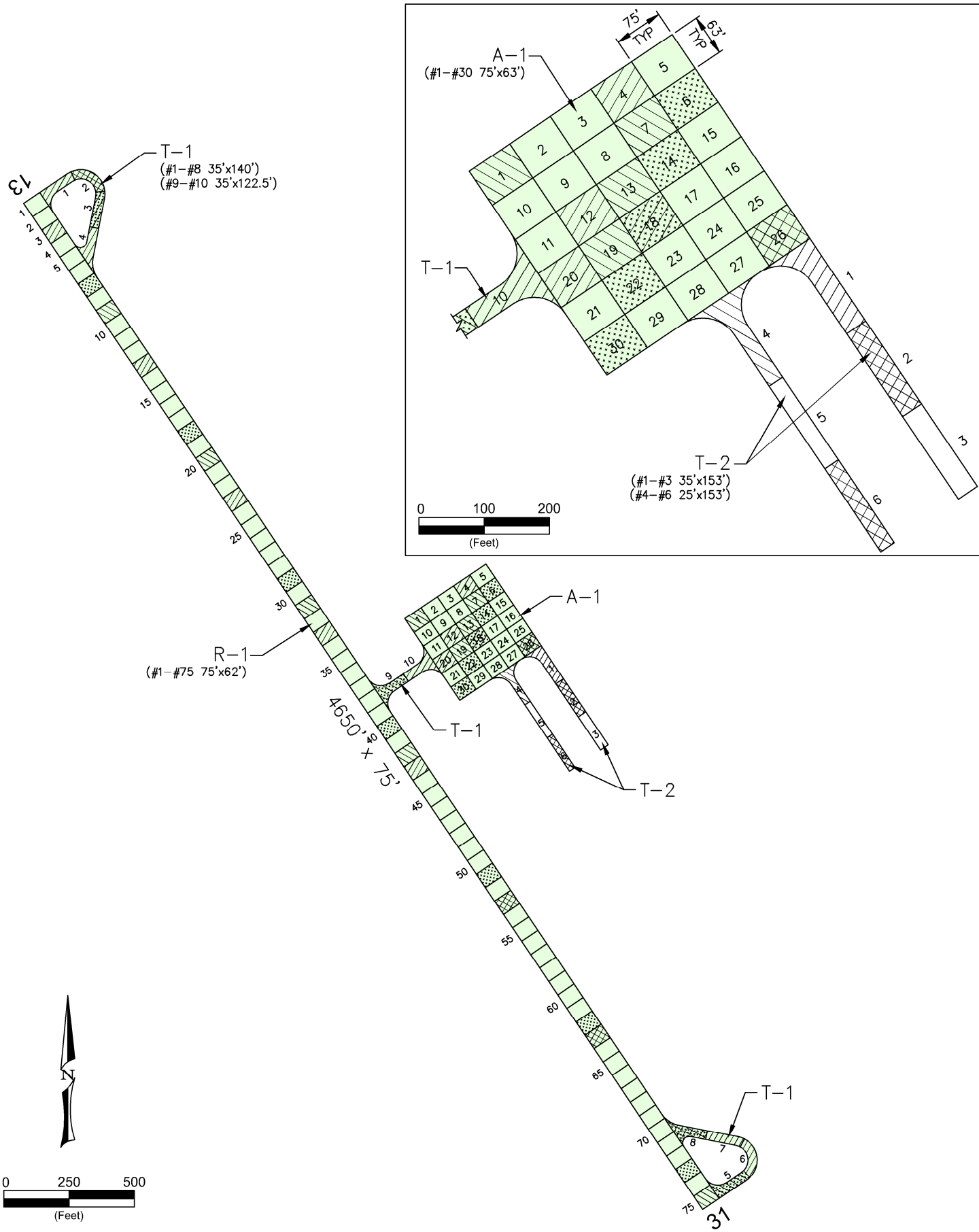

PAVEMENT STRENGTH SURVEY/PAVEMENT CONDITION SURVEY

PAVE. IDENT.	SOIL CLASS	SUB GRADE CLASS	SUBBASE COURSE	BASE COURSE	SURFACE COURSE	OVERLAY	PAVEMENT STRENGTH			REMARKS
							MAX. GROSS LOAD (LBS)			
							SINGLE	DUAL	DUAL TAN.	
RUNWAYS										
R-1	CBR=7.2	6" COMP. P-152 FILTER FABRIC	8" P-154	3" P-208	3" P-401	P-609	12,500			1,2
TAXIWAYS										
T-1	CBR=7.2	6" COMP. P-152 FILTER FABRIC	8" P-154	3" P-208	3" P-401	P-609	12,500			1,2
T-2	CBR=7.2	6" COMP. P-152 FILTER FABRIC	8" P-154	3" P-208	3" P-401	P-609	12,500			1,2
APRONS										
A-1	CBR=7.2	6" COMP. P-152 FILTER FABRIC	8" P-154	3" P-208	3" P-401	P-609	12,500			1,2

- REMARKS:**
- AIP-005-2006, ALL NEW CONSTRUCTION
 - AIP-008-2011, CRACK SEAL, FOG SEAL, AND REMARK ALL PAVEMENTS.

LEGEND <input type="checkbox"/> 2003 SURVEY AREA (N/A) <input type="checkbox"/> 2006 SURVEY AREA (N/A) <input checked="" type="checkbox"/> 2009 SURVEY AREA <input checked="" type="checkbox"/> 2012 SURVEY AREA <input checked="" type="checkbox"/> 2015 SURVEY AREA <input checked="" type="checkbox"/> MAINTAIN: PCI > 60 <input checked="" type="checkbox"/> TRANSITION: PCI 45 TO 60 <input checked="" type="checkbox"/> RECONSTRUCT: PCI < 45	DATE OF PAVEMENT STRENGTH SURVEY: EVALUATED BY:	MONTANA AVIATION SYSTEM PLAN 2015 UPDATE - PAVEMENT CONDITION INDEXES PENN STOHR FIELD (S34)
	DATE OF MOST RECENT PAVEMENT CONDITION SURVEY: SEPT. 23, 2015 EVALUATED BY: S. MARKWARDT	
	LOCATION: PLAINS MONTANA	

PLAINS

PLAINS AIRPORT

9/23/2015



A-1, Overview

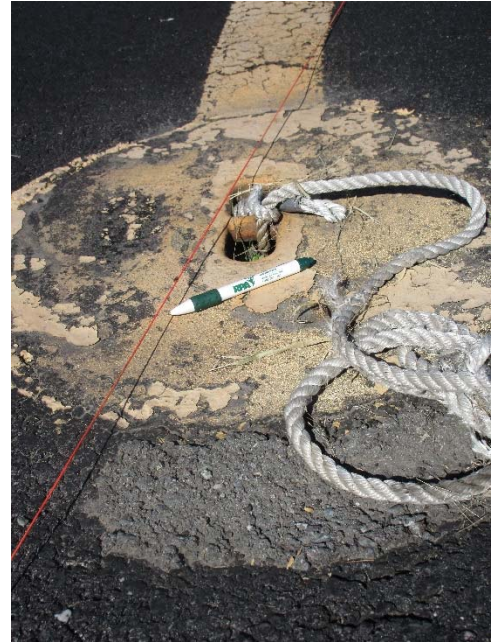

A-1, Surface detail with patch & depression



R-1, Surface detail



R-1, Pavement overview

PLAINS AIRPORT

9/23/2015

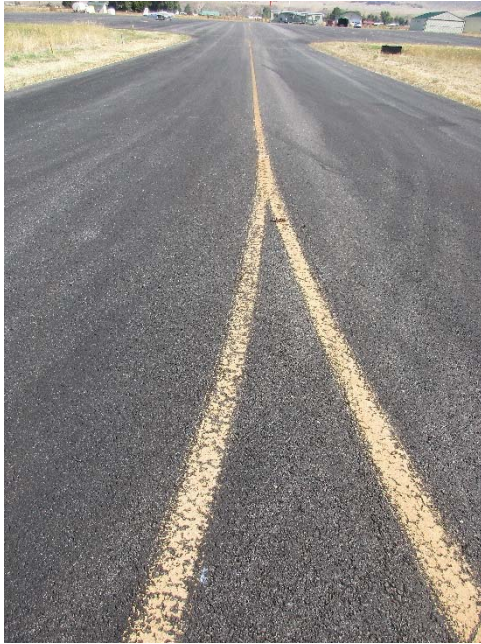

T-1, Overview



T-1, Surface detail

PLAINS AIRPORT

Branch: 63A

APRON

A-1

Length: 378 LF **Width:** 375 LF **Area:** 141,750 SF **Last Const. :** 2006 **Family:** ACAM15
From: APRON **To:** T-1 **Surface:** AC

Inspections

Samples Surveyed: 5 **Total Samples:** 30 **Last Inspection Date (RPA)** 9/23/2015 **PCI:** 82

Sample # 6 **Area:** 4725 SF

Distress Description	Severity	Quantity
WEATHERING	L	94 SF
RAVELING	L	24 SF
DEPRESSION	L	4 SF
OIL SPILLAGE	N	3 SF
PATCHING	L	1 SF

Sample # 14 **Area:** 4725 SF

Distress Description	Severity	Quantity
LONGITUDINAL/TRANSVERSE CRACKING	L	57 LF
WEATHERING	L	94 SF
RAVELING	L	24 SF
RAVELING	H	5 SF
OIL SPILLAGE	N	1 SF

Sample # 18 **Area:** 4725 SF

Distress Description	Severity	Quantity
LONGITUDINAL/TRANSVERSE CRACKING	L	113 LF
WEATHERING	L	94 SF
RAVELING	L	24 SF
RAVELING	H	1 SF
PATCHING	L	1 SF
OIL SPILLAGE	N	1 SF

Sample # 22 **Area:** 4725 SF

Distress Description	Severity	Quantity
WEATHERING	L	94 SF
RAVELING	L	24 SF
DEPRESSION	L	20 SF
PATCHING	M	15 SF
OIL SPILLAGE	N	2 SF

Sample # 30 **Area:** 4725 SF

Distress Description	Severity	Quantity
LONGITUDINAL/TRANSVERSE CRACKING	L	212 LF
SWELLING	L	94 SF
DEPRESSION	L	26 SF
RAVELING	L	24 SF
PATCHING	L	5 SF
RAVELING	H	2 SF

Extrapolated Distress Quantities*

Distress Description	Severity	Quantity	Density	Deduct
LONGITUDINAL/TRANSVERSE CRACKING	L	2292 LF	1.62 %	6.41
PATCHING	M	90 SF	0.06 %	6.20
RAVELING	H	48 SF	0.03 %	6.00
OIL SPILLAGE	N	42 SF	0.03 %	2.00
PATCHING	L	42 SF	0.03 %	2.00
RAVELING	L	720 SF	0.51 %	1.78
SWELLING	L	564 SF	0.40 %	1.74
DEPRESSION	L	300 SF	0.21 %	0.87
WEATHERING	L	2256 SF	1.59 %	0.62

* Multiple deduct values are scaled down from their algebraic sum to keep the model consistent with experimental data.

Percent of Deduct Values Based on Distress Mechanism

0.0 % Load 83.0 % Climate/Durability 17.0 % Other

PLAINS AIRPORT

Branch: 63R

RUNWAY

R-1

Length: 4,650 LF **Width:** 75 LF **Area:** 348,750 SF **Last Const. :** 2006 **Family:** ACRML15
From: STA. 12+00 RWY 13/31 **To:** STA. 58+50 RWY 13/31 **Surface:** AC

Inspections

Samples Surveyed: 7 **Total Samples:** 75 **Last Inspection Date (RPA)** 9/23/2015 **PCI:** 75

Sample # 7 **Area:** 4875 SF

Distress Description	Severity	Quantity
LONGITUDINAL/TRANSVERSE CRACKING	L	154 LF
LONGITUDINAL/TRANSVERSE CRACKING	M	54 LF
WEATHERING	L	98 SF
RAVELING	L	24 SF
RAVELING	H	4 SF

Sample # 18 **Area:** 4875 SF

Distress Description	Severity	Quantity
WEATHERING	M	650 SF
LONGITUDINAL/TRANSVERSE CRACKING	L	178 LF
WEATHERING	L	98 SF
RAVELING	L	24 SF
LONGITUDINAL/TRANSVERSE CRACKING	M	3 LF
RAVELING	H	3 SF

Sample # 29 **Area:** 4875 SF

Distress Description	Severity	Quantity
LONGITUDINAL/TRANSVERSE CRACKING	L	101 LF
LONGITUDINAL/TRANSVERSE CRACKING	M	56 LF
WEATHERING	L	98 SF
RAVELING	L	24 SF
RAVELING	H	3 SF

Sample # 40 **Area:** 4875 SF

Distress Description	Severity	Quantity
LONGITUDINAL/TRANSVERSE CRACKING	L	128 LF
WEATHERING	L	98 SF
LONGITUDINAL/TRANSVERSE CRACKING	M	25 LF
RAVELING	L	24 SF
RAVELING	H	2 SF

Sample # 51 **Area:** 4875 SF

Distress Description	Severity	Quantity
LONGITUDINAL/TRANSVERSE CRACKING	L	128 LF
LONGITUDINAL/TRANSVERSE CRACKING	M	30 LF
WEATHERING	L	98 SF
RAVELING	L	24 SF
RAVELING	H	3 SF
PATCHING	L	2 SF

Sample # 62 **Area:** 4875 SF

Distress Description	Severity	Quantity
LONGITUDINAL/TRANSVERSE CRACKING	L	167 LF
WEATHERING	L	98 SF
LONGITUDINAL/TRANSVERSE CRACKING	M	15 LF
RAVELING	L	24 SF
RAVELING	H	2 SF
PATCHING	L	2 SF

Sample # 73 **Area:** 4875 SF

Distress Description	Severity	Quantity
LONGITUDINAL/TRANSVERSE CRACKING	L	163 LF
LONGITUDINAL/TRANSVERSE CRACKING	M	30 LF
WEATHERING	L	98 SF
RAVELING	L	24 SF
RAVELING	H	5 SF
PATCHING	L	1 SF

Extrapolated Distress Quantities*

Distress Description	Severity	Quantity	Density	Deduct
LONGITUDINAL/TRANSVERSE CRACKING	L	10414 LF	2.99 %	10.01
LONGITUDINAL/TRANSVERSE CRACKING	M	2177 LF	0.62 %	9.14
RAVELING	H	225 SF	0.06 %	6.00
WEATHERING	M	6643 SF	1.90 %	2.21

PLAINS AIRPORT

Branch: 63R

RUNWAY

R-1

Extrapolated Distress Quantities*

Distress Description	Severity	Quantity	Density	Deduct
PATCHING	L	51 SF	0.01 %	2.00
RAVELING	L	1717 SF	0.49 %	1.76
WEATHERING	L	7011 SF	2.01 %	0.69

* Multiple deduct values are scaled down from their algebraic sum to keep the model consistent with experimental data.

Percent of Deduct Values Based on Distress Mechanism

0.0 % Load 100.0 % Climate/Durability 0.0 % Other

PLAINS AIRPORT**FIFTEEN YEAR PROJECTIONS: ESTIMATED AVERAGE ANNUAL COST: \$208,296**

PLAN YEAR: 2016			ESTIMATED COST:			\$244,390	PCI	
SectionID	Maintenance	Local	Global	Major<Crit	Major>Crit	Total	before	after
T-1	Prev. & Thin AC	\$337	\$93,161			\$93,498	83	100
A-1	Prev. & Seal Coat	\$1,638	\$39,690			\$41,328	80	86
R-1	Prev. & Seal Coat	\$11,913	\$97,650			\$109,564	74	77
PLAN YEAR: 2017			ESTIMATED COST:			\$11,250	PCI	
SectionID	Maintenance	Local	Global	Major<Crit	Major>Crit	Total	before	after
A-1	Basic Prev.	\$1,035				\$1,035	83	83
R-1	Basic Prev.	\$10,215				\$10,215	75	75
PLAN YEAR: 2018			ESTIMATED COST:			\$13,936	PCI	
SectionID	Maintenance	Local	Global	Major<Crit	Major>Crit	Total	before	after
A-1	Basic Prev.	\$1,534				\$1,534	80	80
R-1	Basic Prev.	\$12,402				\$12,402	74	74
PLAN YEAR: 2019			ESTIMATED COST:			\$18,105	PCI	
SectionID	Maintenance	Local	Global	Major<Crit	Major>Crit	Total	before	after
A-1	Basic Prev.	\$3,271				\$3,271	77	77
T-1	Basic Prev.	\$141				\$141	87	88
R-1	Basic Prev.	\$14,693				\$14,693	73	73
PLAN YEAR: 2020			ESTIMATED COST:			\$22,500	PCI	
SectionID	Maintenance	Local	Global	Major<Crit	Major>Crit	Total	before	after
T-1	Basic Prev.	\$296				\$296	84	85
R-1	Basic Prev.	\$17,208				\$17,208	72	72
A-1	Basic Prev.	\$4,996				\$4,996	75	75
PLAN YEAR: 2021			ESTIMATED COST:			\$186,417	PCI	
SectionID	Maintenance	Local	Global	Major<Crit	Major>Crit	Total	before	after
R-1	Prev. & Seal Coat	\$20,054	\$113,203			\$133,257	70	73
T-1	Basic Prev.	\$437				\$437	82	82
A-1	Prev. & Seal Coat	\$6,711	\$46,012			\$52,723	72	78
PLAN YEAR: 2022			ESTIMATED COST:			\$23,571	PCI	
SectionID	Maintenance	Local	Global	Major<Crit	Major>Crit	Total	before	after
T-1	Basic Prev.	\$565				\$565	80	80
A-1	Basic Prev.	\$5,098				\$5,098	75	75
R-1	Basic Prev.	\$17,908				\$17,908	72	72
PLAN YEAR: 2023			ESTIMATED COST:			\$28,779	PCI	
SectionID	Maintenance	Local	Global	Major<Crit	Major>Crit	Total	before	after
R-1	Basic Prev.	\$20,880				\$20,880	70	70
T-1	Basic Prev.	\$975				\$975	78	78
A-1	Basic Prev.	\$6,924				\$6,924	73	73
PLAN YEAR: 2024			ESTIMATED COST:			\$37,842	PCI	
SectionID	Maintenance	Local	Global	Major<Crit	Major>Crit	Total	before	after
T-1	Basic Prev.	\$1,372				\$1,372	77	77
R-1	Basic Prev.	\$27,700				\$27,700	69	69
A-1	Basic Prev.	\$8,770				\$8,770	70	70
PLAN YEAR: 2025			ESTIMATED COST:			\$51,444	PCI	
SectionID	Maintenance	Local	Global	Major<Crit	Major>Crit	Total	before	after
T-1	Basic Prev.	\$1,752				\$1,752	75	76
A-1	Basic Prev.	\$12,744				\$12,744	68	68
R-1	Basic Prev.	\$36,948				\$36,948	67	67
PLAN YEAR: 2026			ESTIMATED COST:			\$377,300	PCI	
SectionID	Maintenance	Local	Global	Major<Crit	Major>Crit	Total	before	after
T-1	Prev. & Thin AC	\$2,132	\$125,201			\$127,333	74	83
R-1	Prev. & Seal Coat	\$48,228	\$131,234			\$179,462	65	69
A-1	Prev. & Seal Coat	\$17,165	\$53,340			\$70,505	66	71
PLAN YEAR: 2027			ESTIMATED COST:			\$51,211	PCI	
SectionID	Maintenance	Local	Global	Major<Crit	Major>Crit	Total	before	after
A-1	Basic Prev.	\$12,990				\$12,990	68	69
R-1	Basic Prev.	\$37,606				\$37,606	67	67
T-1	Basic Prev.	\$615				\$615	81	81

PLAN YEAR: 2028			ESTIMATED COST:			\$67,971	PCI	
SectionID	Maintenance	Local	Global	Major<Crit	Major>Crit	Total	before	after
T-1	Basic Prev.	\$989				\$989	79	79
A-1	Basic Prev.	\$17,706				\$17,706	66	66
R-1	Basic Prev.	\$49,276				\$49,276	65	65
PLAN YEAR: 2029			ESTIMATED COST:			\$87,574	PCI	
SectionID	Maintenance	Local	Global	Major<Crit	Major>Crit	Total	before	after
A-1	Basic Prev.	\$22,606				\$22,606	64	64
R-1	Basic Prev.	\$63,506				\$63,506	63	63
T-1	Basic Prev.	\$1,462				\$1,462	77	77
PLAN YEAR: 2030			ESTIMATED COST:			\$1,902,156	PCI	
SectionID	Maintenance	Local	Global	Major<Crit	Major>Crit	Total	before	after
A-1	Basic Prev.	\$27,829				\$27,829	62	62
T-1	Basic Prev.	\$1,910				\$1,910	76	76
R-1	Reconstruct			\$1,872,417		\$1,872,417	60	100