

TWIN BRIDGES

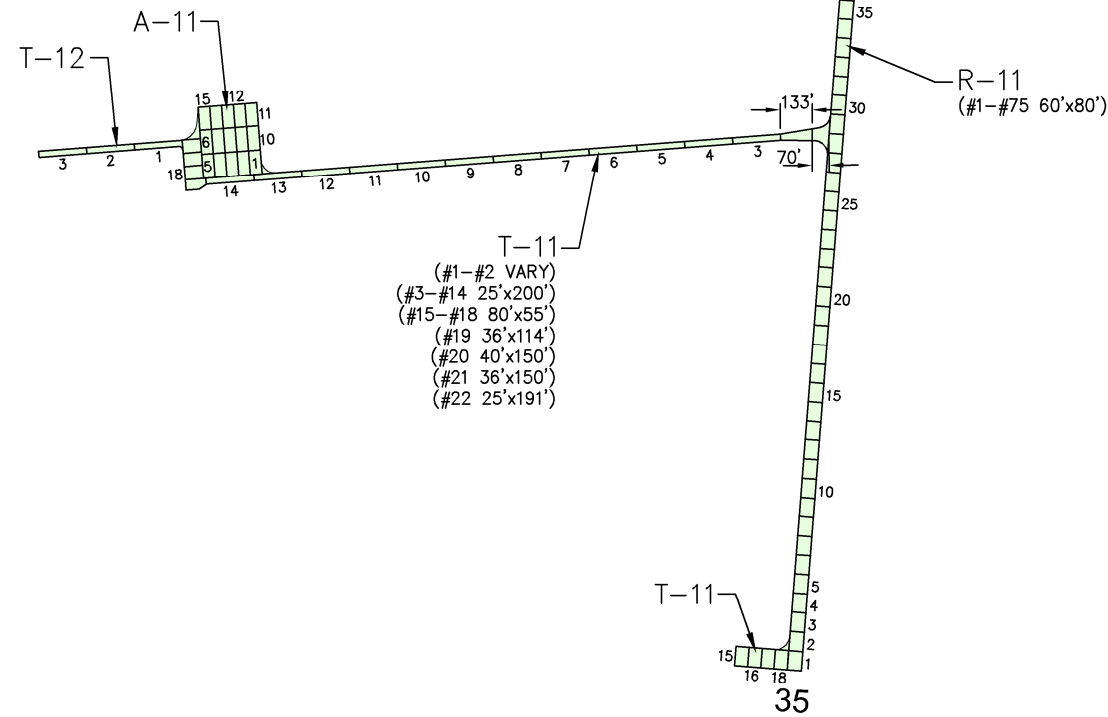
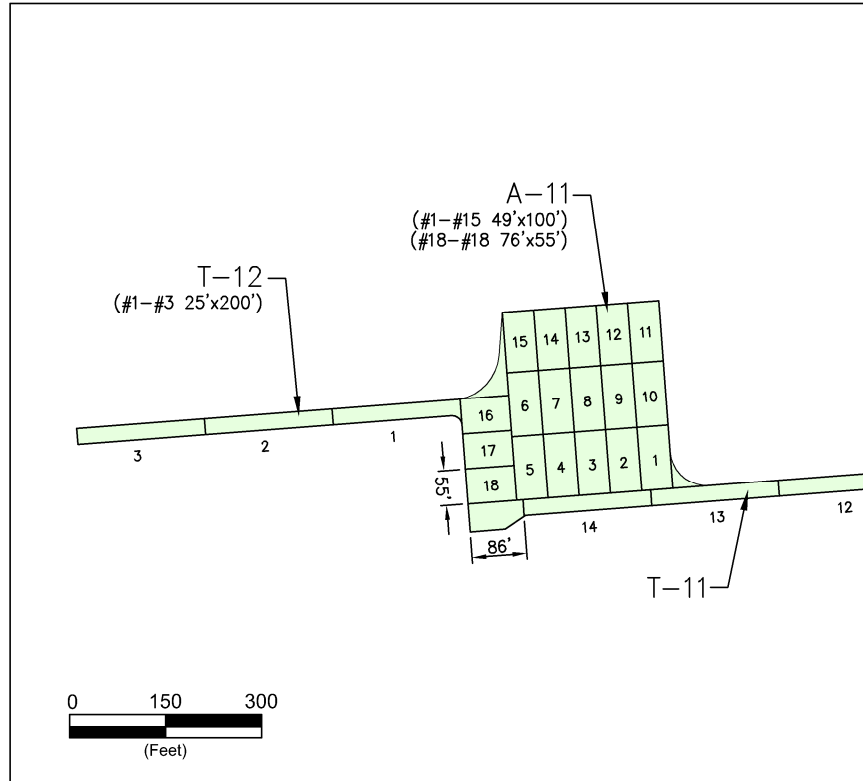

PAVEMENT STRENGTH SURVEY/PAVEMENT CONDITION SURVEY

PAVE. IDENT.	SOIL CLASS	SUB GRADE CLASS	SUBBASE COURSE	BASE COURSE	SURFACE COURSE	OVERLAY	PAVEMENT STRENGTH			REMARKS
							MAX. GROSS LOAD (LBS)			
							SINGLE	DUAL	DUAL TAN.	
RUNWAYS										
R-11	CBR=4		11" P-207	6" P-209	4" P-401		60,000	78,000	99,900	3
TAXIWAYS										
T-11	CBR=4		11" P-207	6" P-209	4" P-401		60,000	78,000	99,900	3
T-12	CBR=4		13" P-207	4" P-209	3" P-401		12,500	30,000		3
APRONS										
A-11	CBR=4		11" P-207	6" P-209	4" P-401		60,000	78,000	99,900	3

REMARKS:

- AIP-003, 1988, ALL NEW PAVEMENTS.
- AIP-004, 2000, OVERLAY EXISTING BITUMINOUS RUNWAY, TAXIWAY, APRON, AND TURNAROUNDS.
- AIP-011-2014, RECONSTRUCT AND LENGTHEN RUNWAY (R-11); CONSTRUCT RUNWAY 17 TURNAROUND (T-11); RECONSTRUCT TAXIWAY (T-11); RECONSTRUCT APRON (A-11); RECONSTRUCT TAXILANE (T-12).

LEGEND <input type="checkbox"/> 2003 SURVEY AREA (N/A) <input type="checkbox"/> 2006 SURVEY AREA (N/A) <input type="checkbox"/> 2009 SURVEY AREA (N/A) <input type="checkbox"/> 2012 SURVEY AREA (N/A) <input checked="" type="checkbox"/> 2015 SURVEY AREA (NOT SURVEYED) <input type="checkbox"/> MAINTAIN: PCI > 60 <input type="checkbox"/> TRANSITION: PCI 45 TO 60 <input type="checkbox"/> RECONSTRUCT: PCI < 45	DATE OF PAVEMENT STRENGTH SURVEY:		MONTANA AVIATION SYSTEM PLAN 2015 UPDATE - PAVEMENT CONDITION INDEXES TWIN BRIDGES AIRPORT (751) Date: DECEMBER 2015 Prepared For: MONTANA DEPARTMENT OF TRANSPORTATION Prepared By: RPA Robert Peccia & Associates, Inc.
	EVALUATED BY:		
	DATE OF MOST RECENT PAVEMENT CONDITION SURVEY:		
	EVALUATED BY:		
LOCATION:	TWIN BRIDGES MONTANA		

TWIN BRIDGES