

Montana Department of Transportation Bridge Bureau Approved Construction Equipment List

Make:	<i>Wirtgen</i>
Model:	<i>WR 250i</i>
Equipment Type:	<i>Milling Machine</i>
Contractor Modifications:	<i>None</i>

Interstate Approval Conditions

Approval Type	<i>Crossing Only</i>
Speed:	<i>No Restriction</i>
Weight:	<i>95,846 lb or less</i>
Traffic:	<i>Approved with regular traffic</i>
Location Restrictions:	<i>No restriction</i>

Non-Interstate Approval Conditions

Approval Type	<i>Denied</i>
Speed:	<i>Denied</i>
Weight:	<i>Denied</i>
Traffic:	<i>Denied</i>
Location Restrictions:	<i>Denied</i>

Comments:

Equipment configuration, weights, and specifications on following pages. Approval does not apply to posted bridges. Other construction equipment is not allowed to operate on or cross bridge at the same time this equipment is on the bridge.

The WR series' range of applications includes soil treatment, consolidation in road construction, and cold recycling of asphalt roads.

The Compact Machine - The WR 200 XLi stands out thanks to its compact dimensions and reduced weight - this usually means it can be transported without a special permit.

The Multipurpose Machine - The WR 240i is ideal for challenging tasks with increased power requirements.

The Powerful Machine - The WR 250i is the high-performance machine in the WR series, designed to meet the greatest challenges.

TECHNICAL SPECIFICATIONS	WR 200 XLi	WR 240i	WR 250i
Milling and Mixing Rotor			
Working width	7 ft 10 in (2,400 mm)		
Working depth ¹⁾	0 to 19.7 in (0 to 500 mm)	0 to 20.1 in (0 to 510 mm)	0 to 22 in (0 to 560 mm)
Tool spacing	20 mm	20 mm	30 mm x 2
Number of tools	150	170	208
Cutting diameter	4 ft 10 in (1,480 mm)		
Engine			
Engine manufacturer	Mercedes Benz / MTU	Cummins	Caterpillar
Type	OM 470 LA / 6R 1100	X-15	C18 ATAAC
Number of cylinders	6		
Power	at 1,900 rpm: 320 kW / 429 HP / 435 PS	at 2,100 rpm: 447 kW / 600 HP / 608 PS	at 1,950 rpm: 563 kW / 755 HP / 766 PS
Maximum power	at 1,600 rpm: 320 kW / 429 HP / 435 PS	at 1,900 rpm: 455 kW / 610 HP / 619 PS	at 1,700 rpm: 563 kW / 755 HP / 766 PS
Displacement	2.8 gal (10.7 l)	3.9 gal (14.9 l)	4.8 gal (18.1 l)
Fuel consumption, full load during mixture of job site operations	19.8 gal/h (75 l/h) 9.2 gal/h (35 l/h)	30.4 gal/h (115 l/h) 14.5 gal/h (55 l/h)	38.8 gal/h (147 l/h) 19 gal/h (72 l/h)
Sound power level in accordance with EN 500-3 Motor: operator's platform	≤106 dB(A) ≥70 dB(A)	≤109 dB(A) ≥72 dB(A)	≤112 dB(A) ≥74 dB(A)
Exhaust emission standard	US EPA Tier 4f		
Electrical System			
Power supply	24 V		
Tank Capacities			
Fuel tank	219.3 gal (830 l)	364.6 gal (1,380 l)	363.3 gal (1,500 l)
Fuel tank when equipped with optional "S-Pack"	-	311.7 gal (1,180 l)	343.4 gal (1,300 l)
AdBlue® / DEF ²⁾	21.1 gal (80 l)	26.4 gal (100 l)	-
Hydraulic oil tank	52.8 gal (200 l)	84.5 gal (320 l)	
Binder container "S-Pack"	-	194.2 ft³ (5.5 m³)	
Water tank	100.4 gal (380 l)	132.1 gal (500 l)	
Additional water tank	-	251 gal (950 l)	
Driving Performance			
Operating speed in milling and travel gear	0 to 700 ft/min (0 to 210 m/min) (7.8 mph (12.6 km/h))		
Max. cross slope	8°		
Ground clearance	approx. 16 in (400 mm)		
Tires			
Tire size, front / rear	620 / 75 R26	28L - 26	
Transport Dimensions			
Dimensions for truck transport (L x B x H)	30 ft 1 in x 9 ft 10 in x 9 ft 10 in (9,160 x 2,990 x 3,000 mm)	30 ft 3 in x 9 ft 10 in x 9 ft 10 in (9,230 x 3,000 x 3,000 mm)	
Dimensions for truck transport with optional "S-Pack" (L x B x H)	-	31 ft 9 in x 9 ft 10 in x 10 ft 1 in (9,680 x 3,000 x 3,080 mm)	



TECHNICAL SPECIFICATIONS	WR 200 XLi	WR 240 i	WR 250 i
Weight of Basic Machine			
Empty weight of machine with standard equipment without fluids	55,556 lbs (25,200 kg)	65,257 lbs (29,600 kg)	68,454 lbs (31,050 kg)
Operating weight, CE ¹⁾	57,100 lbs (25,900 kg)	67,462 lbs (30,600 kg)	70,548 lbs (32,000 kg)
Maximum operating weight (full tanks, full range of equipment)	60,407 lbs (27,400 kg)	90,390 lbs (41,000 kg)	95,681 lbs (43,400 kg)
Weight of Tank Contents			
Water	838 lbs (380 kg)	1,102 lbs (500 kg)	
Additional water tank	—	2,094 lbs (950 kg)	
Fuel (6.9 lbs/gal (0.83 kg/l))	1,521 lbs (690 kg)	2,524 lbs (1,145 kg)	2,745 lbs (1,245 kg)
Fuel (6.9 lbs/gal (0.83 kg/l)) when equipped with optional "S-Pack"	—	2,139 lbs (970 kg)	2,359 lbs (1,070 kg)
AdBlue® / DEF ²⁾	80 kg	100 kg	—
Binding agent (S-Pack)	—	11,023 lbs (5,000 kg)	
Additional Weight			
Operator and Tools			
> Machine operator	165 lbs (75 kg)		
> 5 pick buckets	276 lbs (125 kg)		
Injection system instead of standard			
> Single ESL: Injection system for water or bitumen emulsion	1,014 lbs (460 kg)	860 lbs (390 kg)	
> Dual ESL: Injection system for water and bitumen emulsion	—	1,587 lbs (720 kg)	
> ESL foamed bitumen: Injection system for water and foamed bitumen	—	3,087 lbs (1,400 kg)	
> ESL 1800 L: Injection system for water up to 475.5 gal/min (1,800 l/min)	904 lbs (410 kg)	860 lbs (390 kg)	
> Built-in binding agent spreader (S-Pack) with exhaust filter	—	8,378 lbs (3,800 kg)	
Optional Additional Equipment			
> Additional water tank (empty)	—	926 lbs (420 kg)	

¹⁾ The maximum working depth may deviate from the value indicated due to tolerances and wear

²⁾ AdBlue® is a registered trademark of the German Association of the Automotive Industry (VDA)

³⁾ Machine weight, half-full tanks, vehicle tool kits, machine operator, excluding optional equipment

SIDE VIEW / TOP VIEW WR 240i AND WR 250i

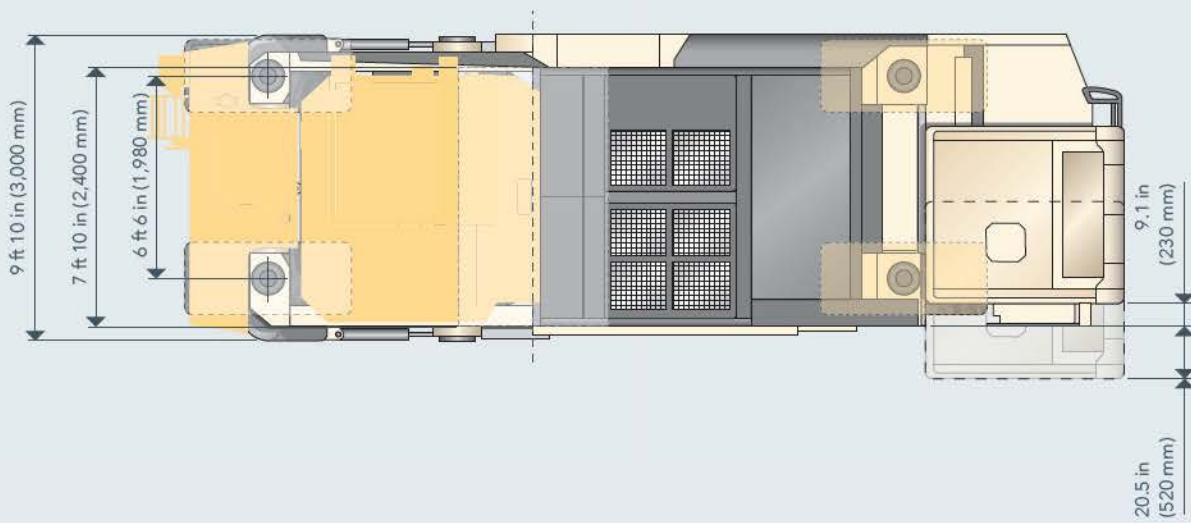
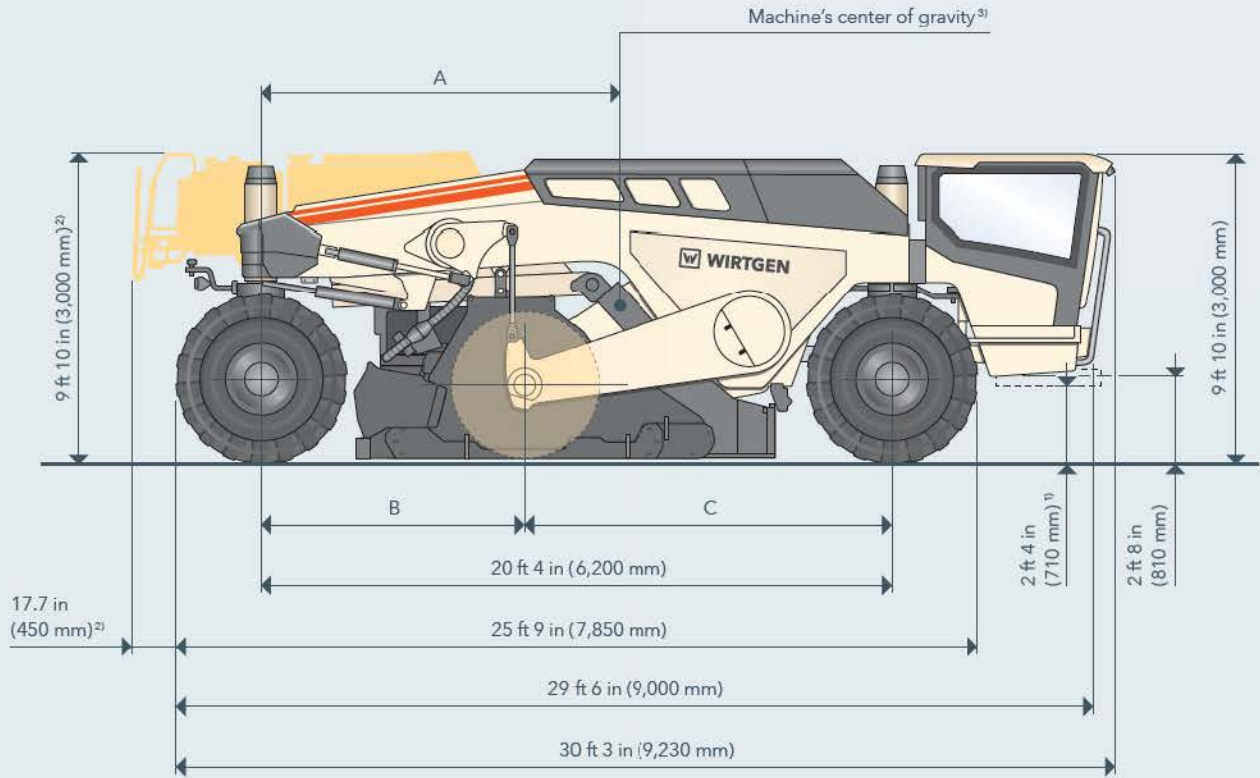

¹⁾ with injection system

²⁾ with S-Pack

³⁾ based on operating weight, CE

	A	B	C
WR 240i	11 ft 8 in (3,550 mm)	8 ft 6 in (2,600 mm)	11 ft 10 in (3,600 mm)
WR 250i	11 ft 6 in (3,500 mm)	8 ft 4 in (2,550 mm)	12 ft (3,650 mm)

TURNING RADIUS WR 200 XLi, WR 240i AND **WR 250i**

WR 200 XLi: $R_{min} = 9\text{ ft } 8\text{ in } (2,950\text{ mm})$
WR 240i / WR 250i: $R_{min} = 10\text{ ft } 4\text{ in } (3,150\text{ mm})$

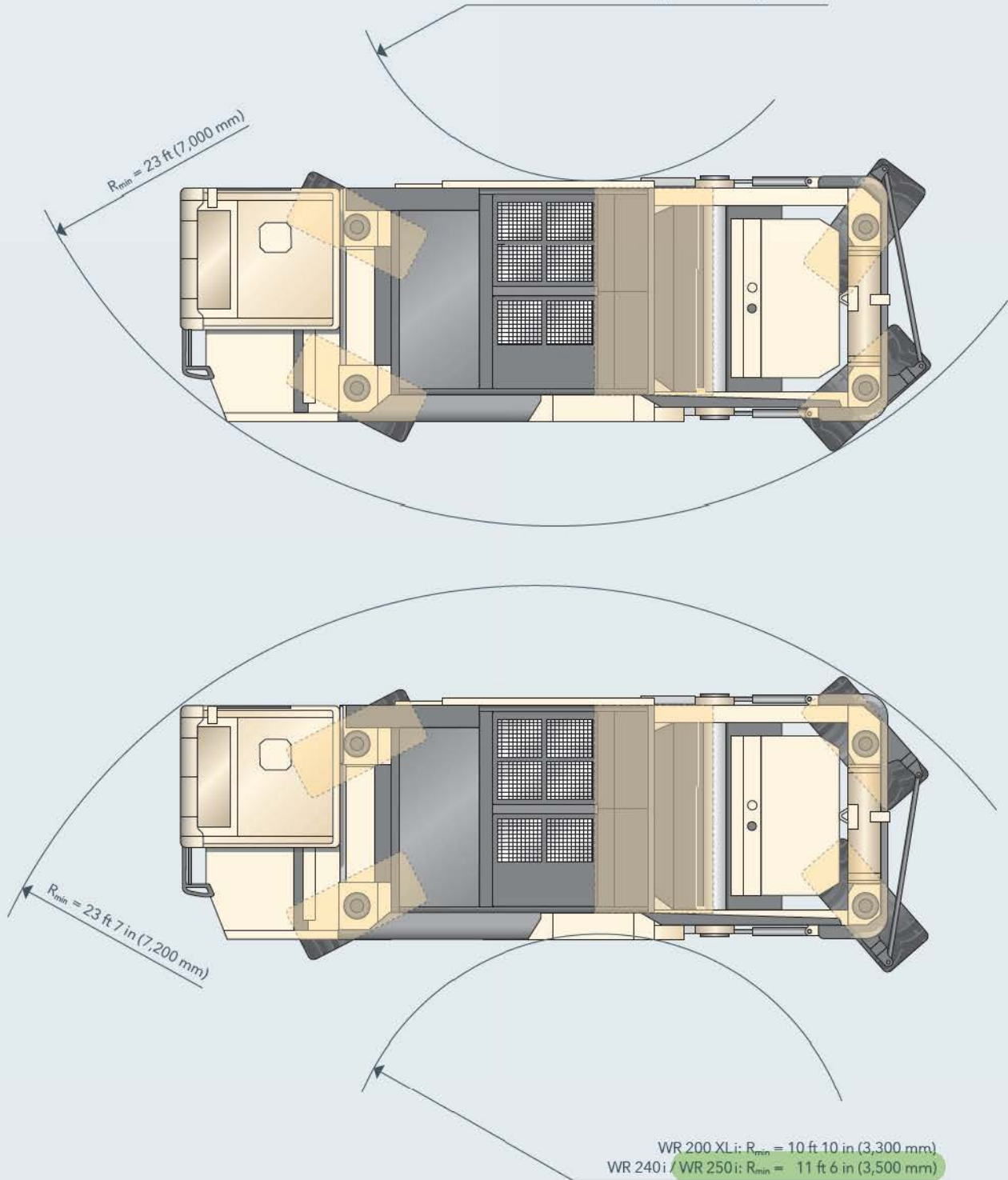

REAR VIEW WR 200 XLi, WR 240i AND WR 250i

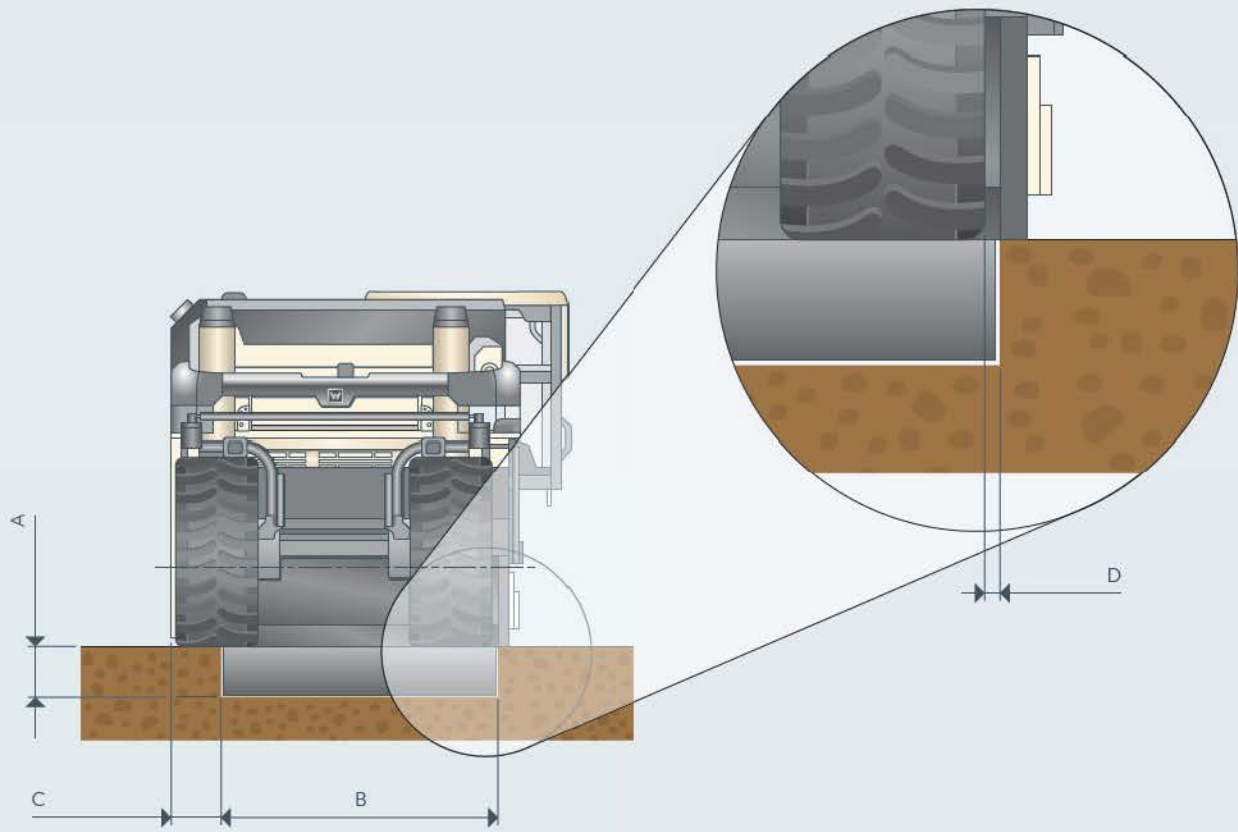

	A	B	C	D
WR 200 XLi	19.7 in (500 mm)	7 ft 10 in (2,400 mm)	15.9 in (405 mm)	approx. 8.9 in (225 mm)
WR 240i	20.1 in (510 mm)	7 ft 10 in (2,400 mm)	16.5 in (420 mm)	approx. 2 in (50 mm)
WR 250i	22 in (560 mm)	7 ft 10 in (2,400 mm)	16.5 in (420 mm)	approx. 2 in (50 mm)