

ZOO DRIVE
IMPROVEMENTS

OPEN HOUSE

WEDNESDAY, APRIL 2

5 P.M. TO 7 P.M.

Come learn about the Montana Department of Transportation's plans to improve the Zoo Drive corridor in 2025.

ZOO DRIVE

IMPROVEMENTS

Project Overview

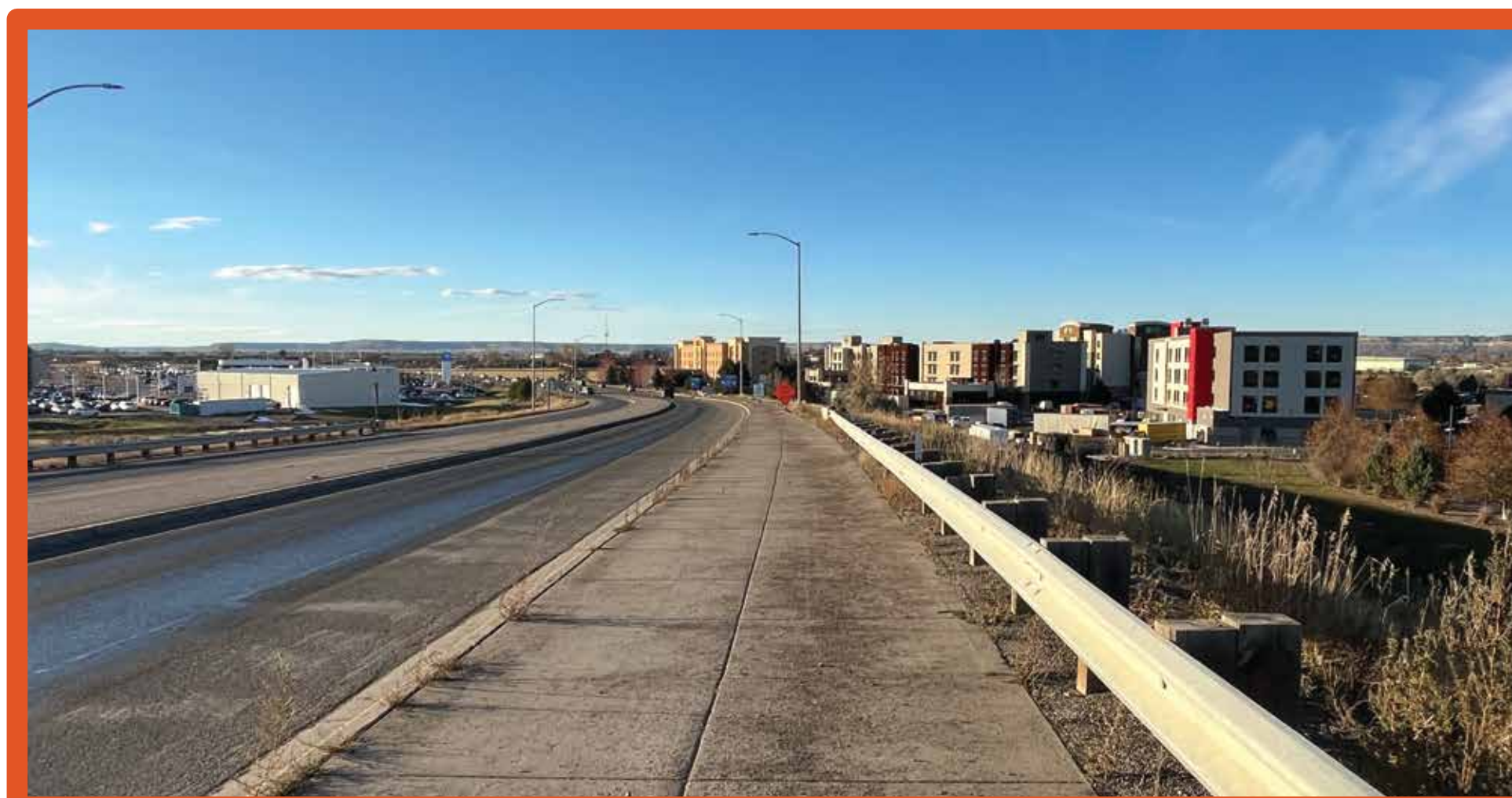
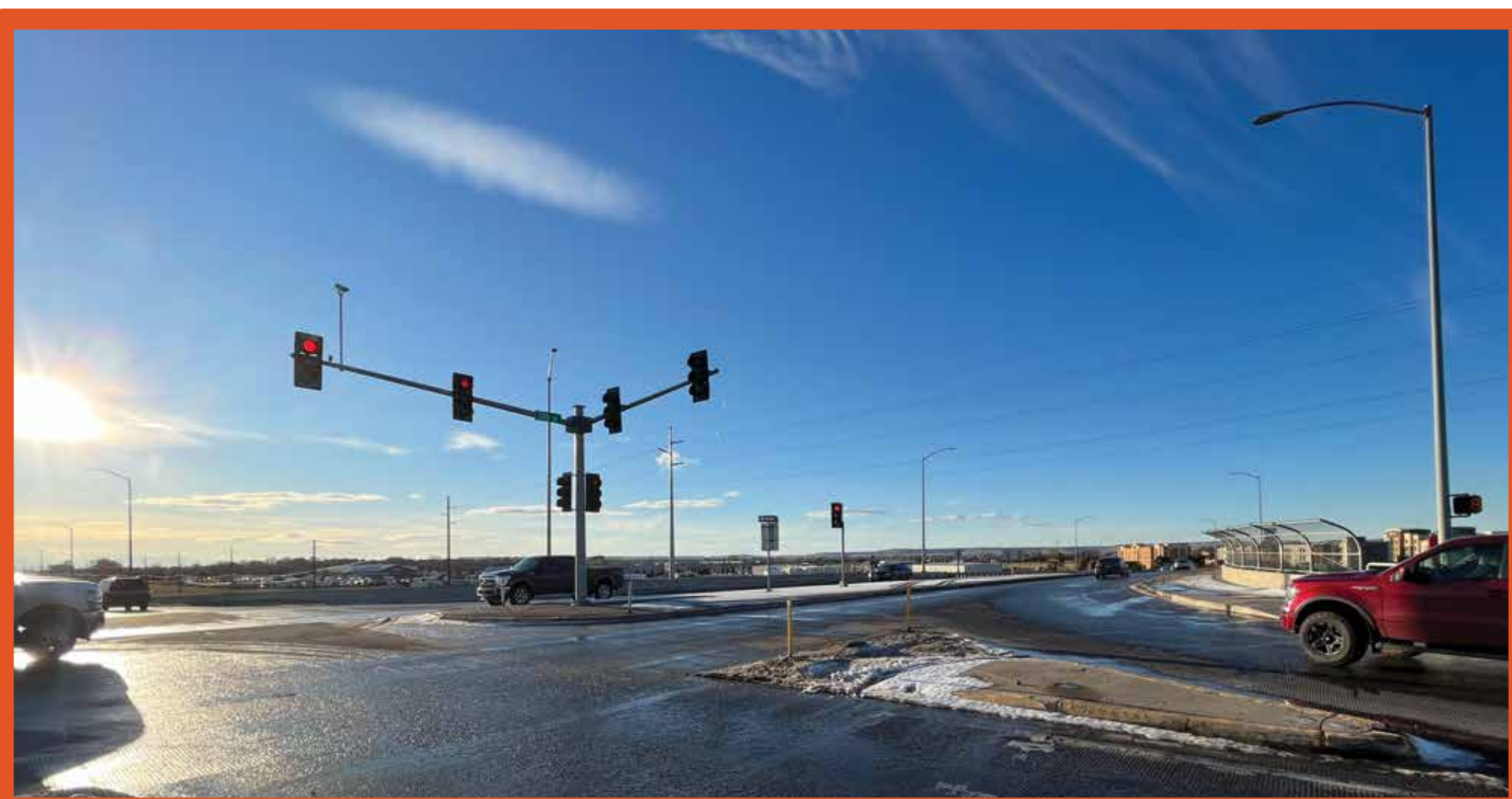

The Montana Department of Transportation (MDT) plans to improve traffic operations and enhance roadway safety features on the Zoo Drive corridor, between Shiloh Road and South Frontage Road, through the *Zoo Drive Improvements* project.

Planned Improvements Include:

- Widening and reconfiguring Zoo Drive to a five-lane roadway with two lanes in each direction and a center turn-lane.
- Widening and reconfiguring a section of Gabel Road between Circle K and the intersection with Zoo Drive to a five-lane layout with four southbound lanes. This will include a second left-turn lane from Gabel Road onto Zoo Drive, toward Interstate 90 (I-90).
- Intersection and traffic signal improvements.
- Pavement marking and signage modifications.
- Median modifications.
- Additional connectivity for pedestrians and bicyclists.
- Americans with Disabilities Act (ADA) upgrades.
- Widening the eastbound I-90 ramps.
- Milling and paving the roadway after modifications.

ZOO DRIVE

IMPROVEMENTS

Project Benefits

The primary goals of the *Zoo Drive Improvements* project are to:



**Improve
Traffic Flow**



**Enhance
Safety Features**



**Add Designated
Facilities for
Pedestrians & Bicyclists**



**Upgrade
ADA Facilities**

ZOO DRIVE

IMPROVEMENTS

Project Map

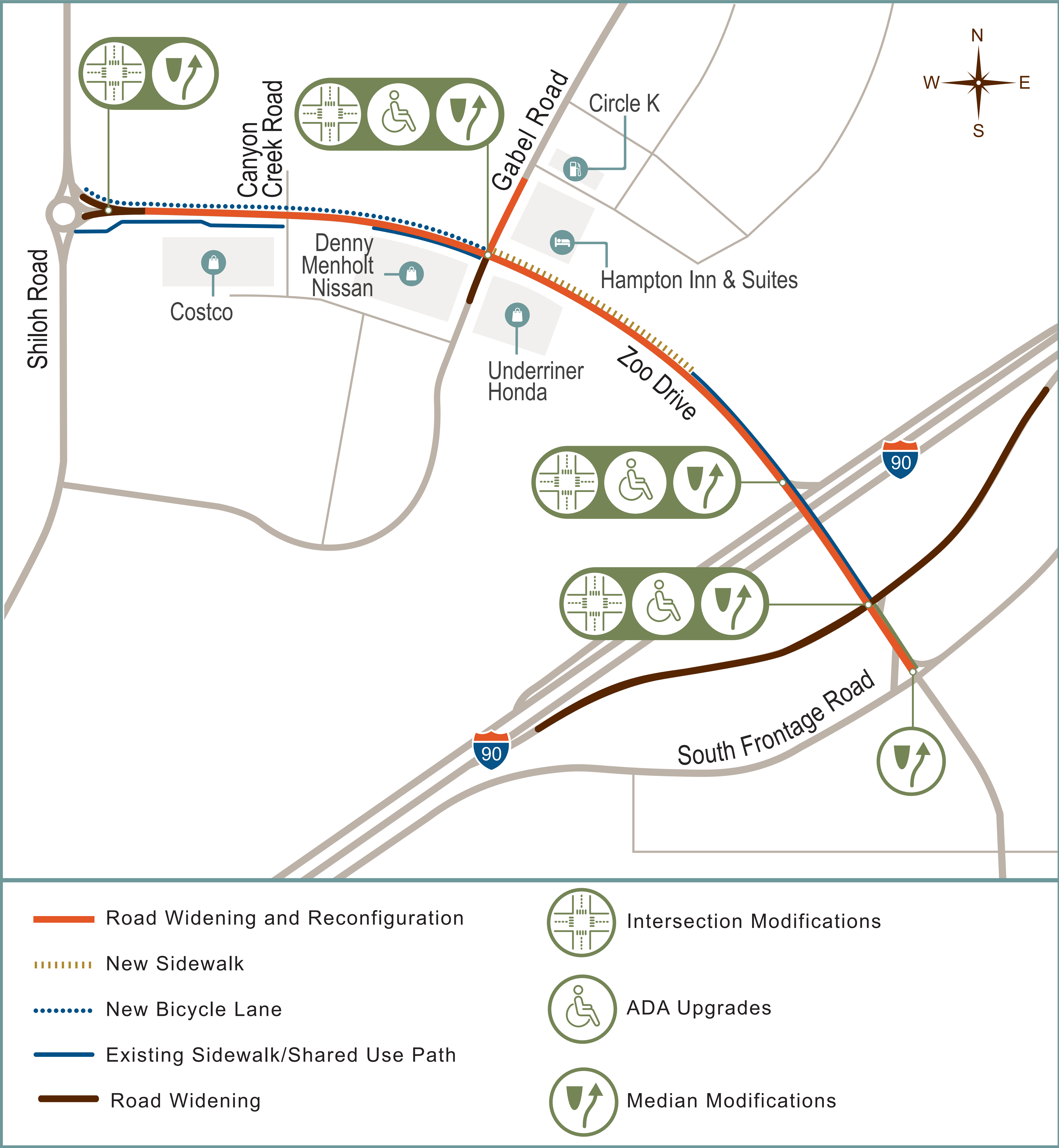

ZOO DRIVE
IMPROVEMENTS

Proposed Intersection Modifications*

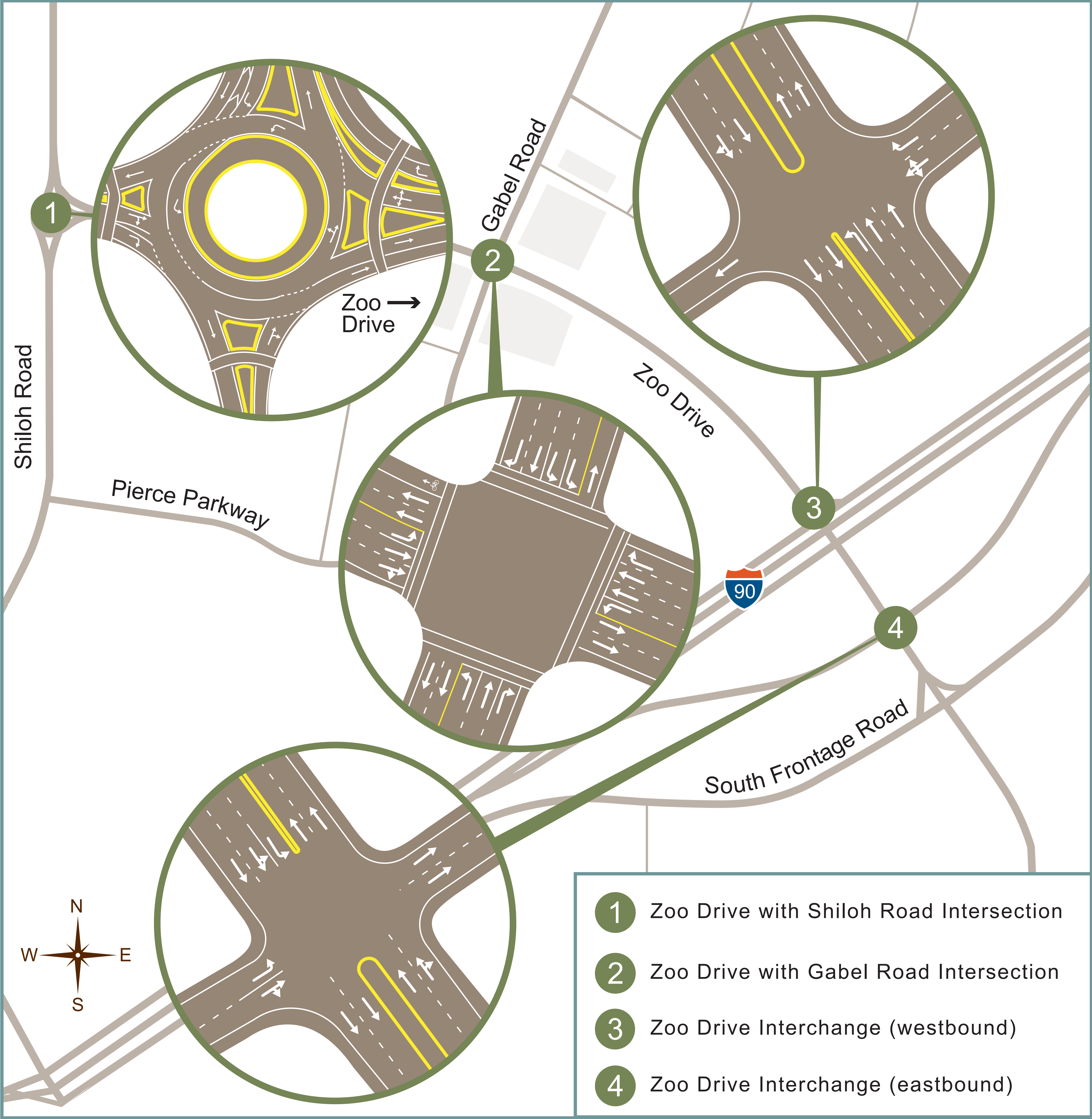

*Conceptual graphics only. Project plans are subject to change.

ZOO DRIVE IMPROVEMENTS

What's Next?

- Knife River is the contractor for this project and plans to begin construction this spring/summer with anticipated completion in the fall of 2025.
- There will be minor disruptions to traffic including temporary lane closures, reduced speeds, and single-lane traffic.
- Zoo Drive is expected to remain open throughout construction with the exception of a short-term closure of Gabel Road and Pierce Parkway for intersection improvements. The closure will temporarily impact business access from Zoo Drive.

You can stay up to date by scanning the QR code for the project website below:



scan here

For More Info:

To receive regular project updates, please email us and request to be added to our email list.

✉ Email: zoodrive@dowl.com

📞 Phone: 406-577-7781

🖱 Website: <https://mdt.mt.gov/pubinvolve/zoodrive/>

💬 *SMS Text Updates: Text ZOODRIVE to 833-648-0322

*Text alerts are not managed by MDT and may have different privacy and security policies. For more information, visit <https://simpletexting.com/privacy-policy/>. Message frequency may vary. Message and data rates may apply. Text STOP to cancel messages.

ZOO DRIVE

IMPROVEMENTS

Zoo Drive*

1 Lane reconfigurations for west leg of Zoo Drive and Gabel Road intersection

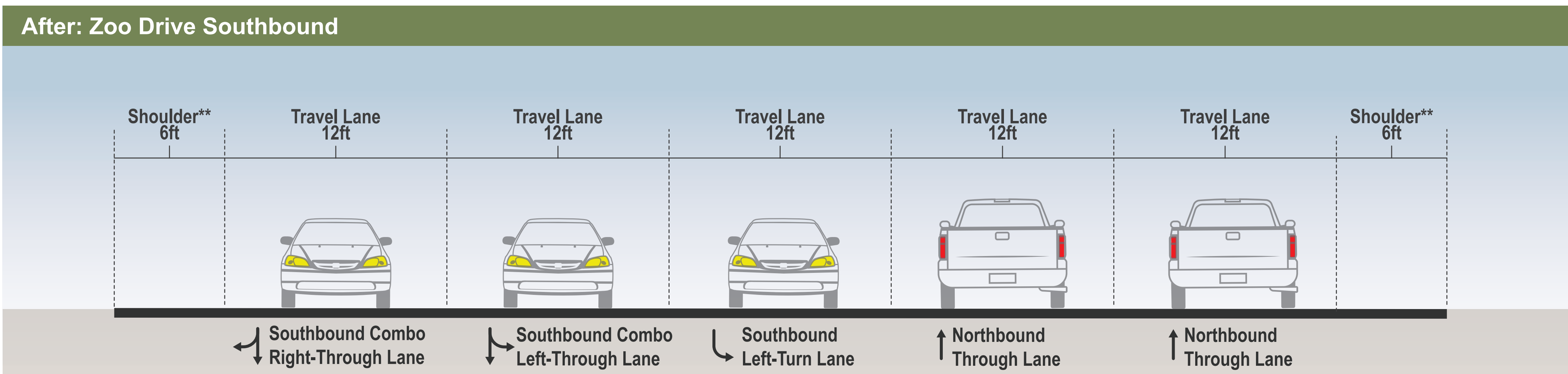
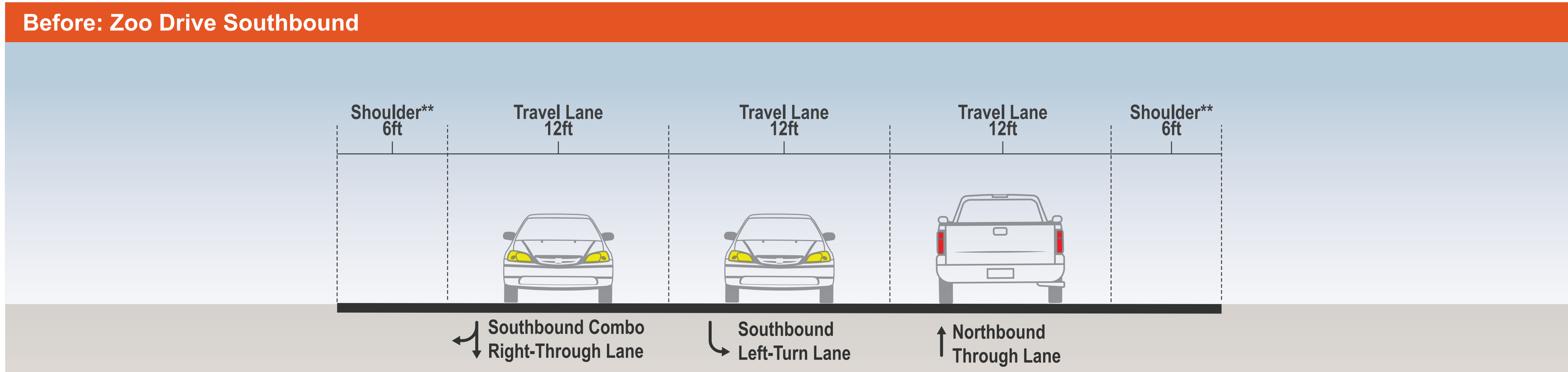

2 Lane reconfigurations for east leg of Zoo Drive and Gabel Road intersection

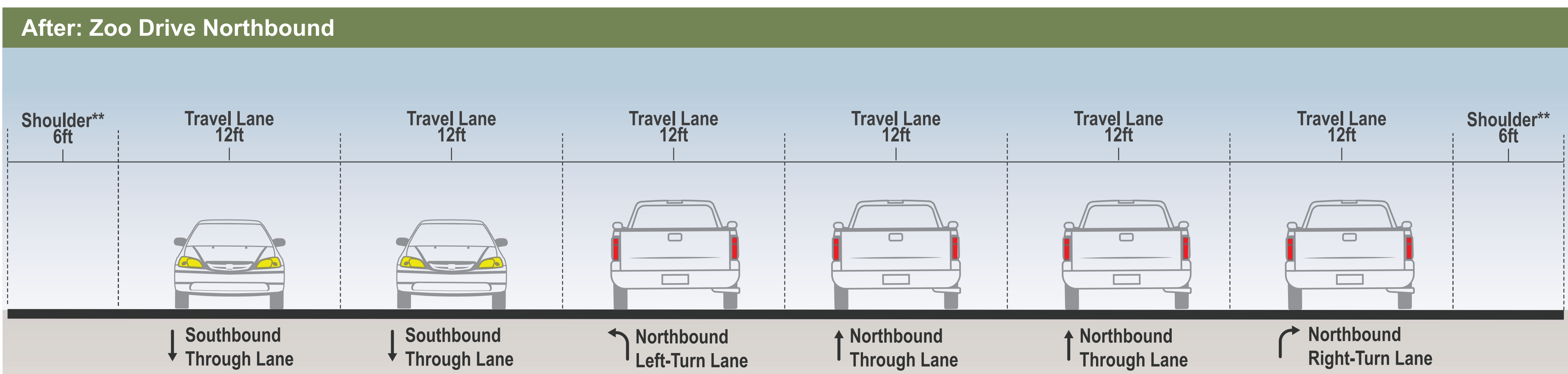
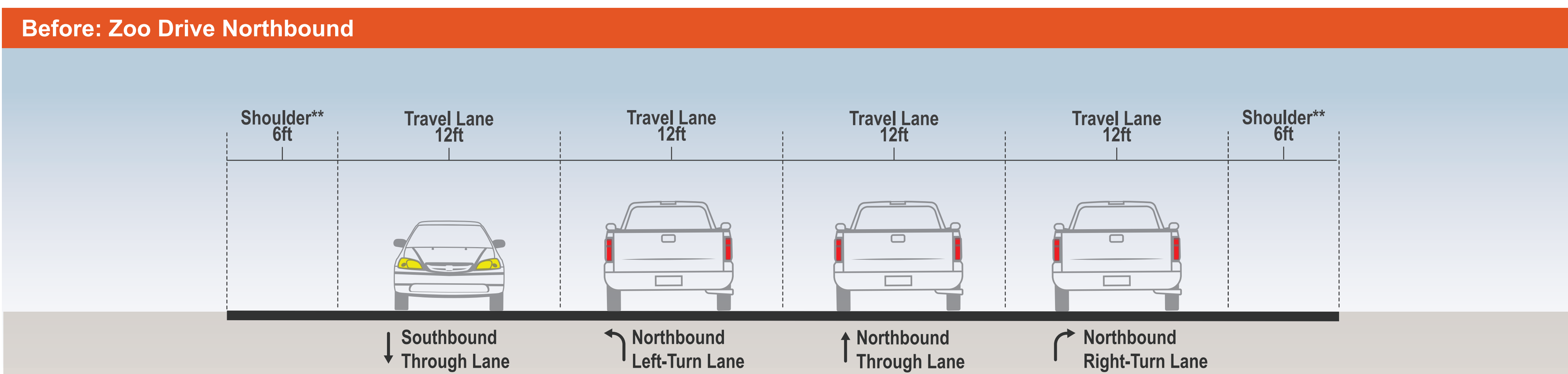

*Conceptual graphics only. Project plans are subject to change.

**Shoulder widths will be less than six feet in some areas of the project to accommodate other project improvements.

ZOO DRIVE

IMPROVEMENTS

Gabel Road*

3 Lane reconfigurations for northeast leg of Gabel Road and Zoo Drive intersection

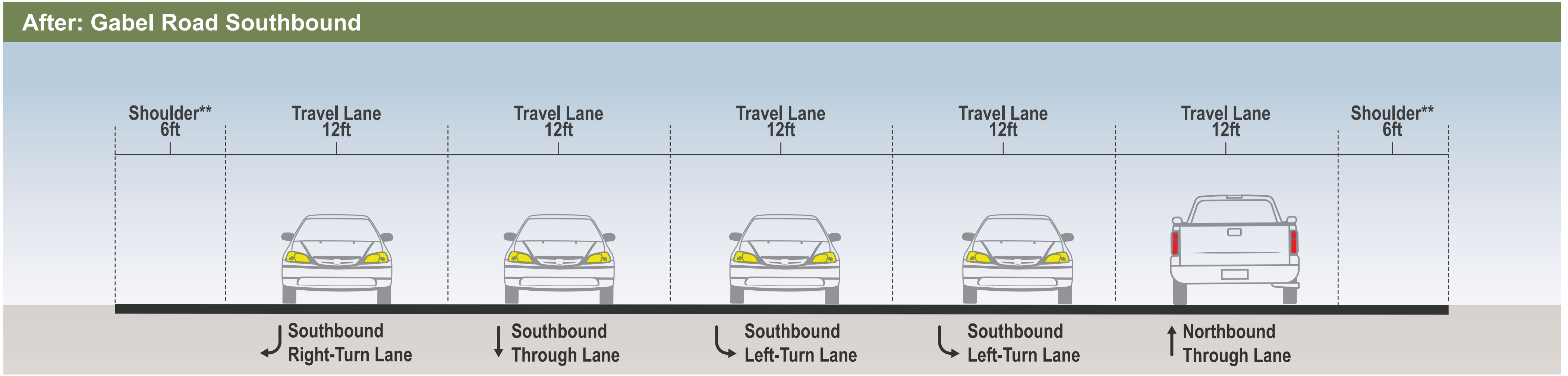
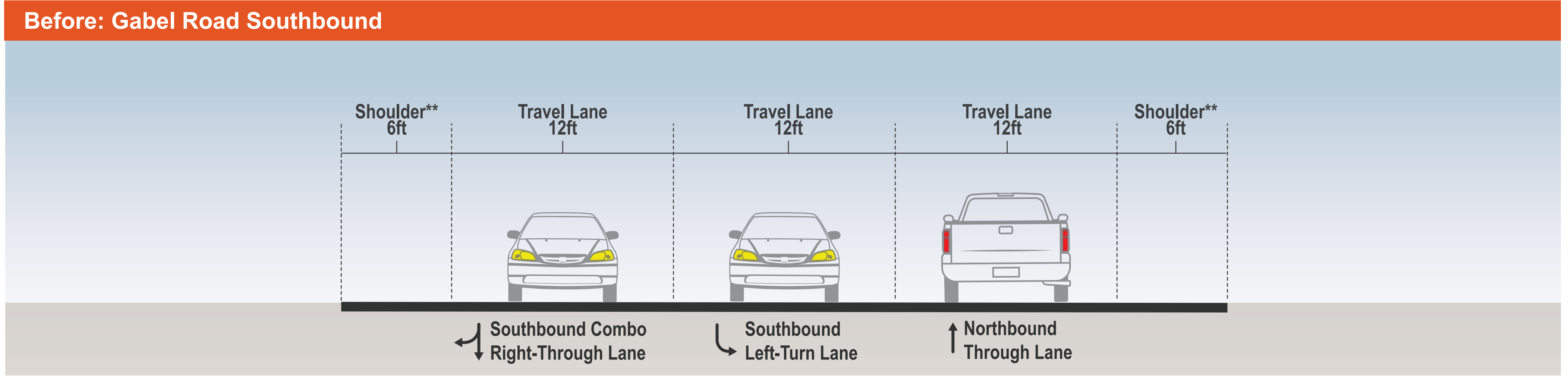

*Conceptual graphics only. Project plans are subject to change.

**Shoulder widths will be less than six feet in some areas of the project to accommodate other project improvements.

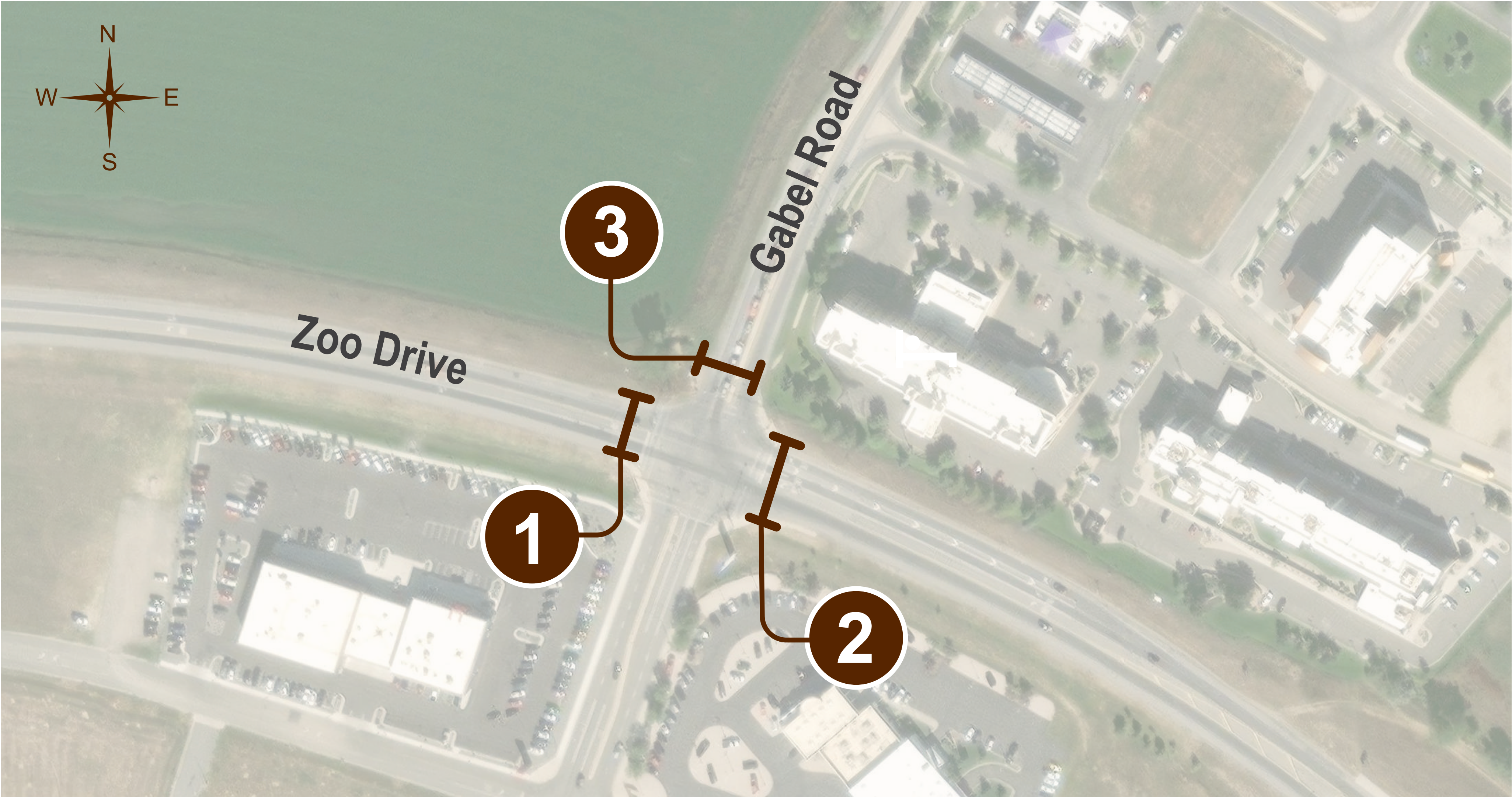

Frequently Asked Questions (FAQs)

How is this project being funded?

Most of this project is being funded with National Highway System (NHS) funds. A smaller portion of the project is being funded through the Highway Safety Improvement Program (HSIP), a federal aid program intended to help reduce traffic fatalities and serious injuries on public roads.

Is Costco contributing to the overall cost of this project?

Costco is not contributing to the cost of the *Zoo Drive Improvements* project. However, Costco was required to complete a Traffic Impact Study (TIS) to identify potential impacts to traffic on the Zoo Drive corridor prior to relocating. As a result, Costco was responsible for adding a traffic signal and a new turn lane for eastbound traffic at the intersection of Zoo Drive with Canyon Creek Road. Costco also added a green arrow to the traffic signals at the eastbound, I-90 on-ramp to help ease congestion when drivers leave Costco and get back on the interstate.

How will this project impact traffic and businesses in the area?

Zoo Drive is expected to remain open throughout construction with the exception of a short-term closure of Gabel Road and Pierce Parkway for intersection improvements. The closure will temporarily impact business access from Zoo Drive. The project team is carefully considering other potential impacts to businesses and will coordinate with them as needed to minimize those impacts.

Will this project include improvements on Shiloh Road as well?

Project plans include minor improvements to the intersection of Zoo Drive with Shiloh Road to transition traffic between the newly configured Zoo Drive and the Shiloh Road roundabout.

Additional questions or comments?

Feel free to ask someone from the project team (wearing a *Zoo Drive Improvements* name badge), fill out a comment card, or see the “What’s Next” display board for information on signing up for project updates or getting in touch.